

# Lead Screw Driven Stages-NEMA-8

NEMA 8 hybrid linear actuator provides a continuous thrust of up to 10 lbsF/45N.



## Available Stroke Selection

Size A	Stroke B
60	20
80	40
100	60
120	80
140	100
160	120
190	150

Motor	Voltage (V)	Current (A)	Resistance ( $\Omega$ )	Inductance (mH)	Lead Wire No.	Motor Length (mm)
8-2105	2.5	0.5	5.1	1.5	4	27.2
8-2205	4.4	0.5	8.8	2.7	4	38.1

## Available Lead Screws and Travel per Step

Screw Diameter (inch)	Screw Diameter (mm)	Lead (inch)	Lead (mm)	Lead Code	Travel Per Step (mm)
0.138	3.5052	0.0118	0.3000	AF	0.0015
0.138	3.5052	0.024	0.6096	AA	0.003
0.138	3.5052	0.0394	1.00	AB	0.005
0.138	3.5052	0.048	1.2192	B	0.0061
0.138	3.5052	0.079	2.00	G	0.01
0.138	3.5052	0.158	4.00	M	0.02
0.138	3.5052	0.315	8.00	T	0.04

NEMA 8 ENCODER OPTIONS

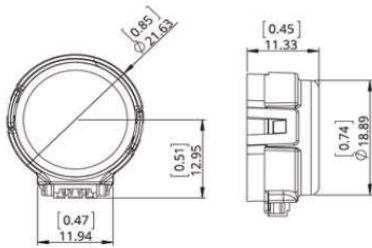

EK1 Encoder - single ended output

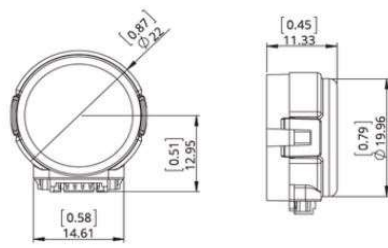

EK1 Encoder - differential output

● EK1 Encoder (Used for Size 8, 11, 14, 17 Motor)\*No Index

Resolution(CPR)	100	108	120	125	128	200	250	256	300	360	400	500	1000	512	720	800
Single ended output	0	1	2	3	4	5	6	7	8	9	10	11	12	13	14	15
Differential output	A	B	C	D	E	F	G	H	I	J	K	L	M	N	O	P

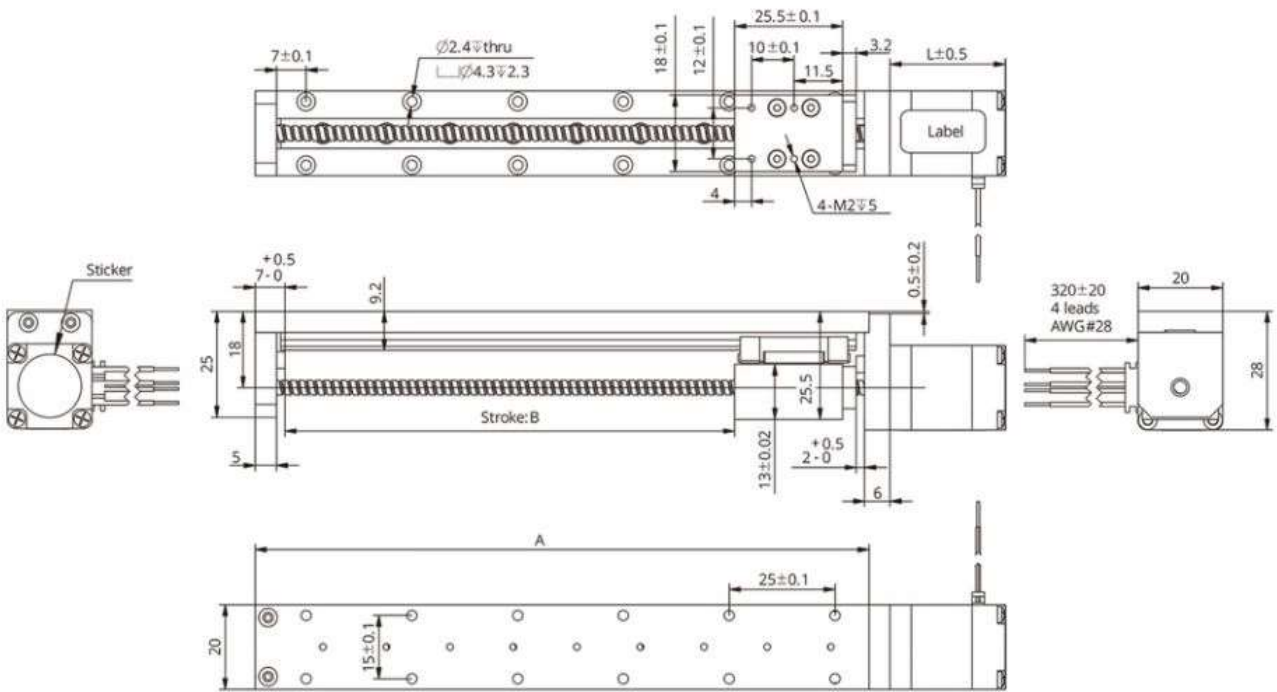

## NEMA 8 SPEED THRUST CURVES

All speed / thrust curves below are generated using 8:1 microstepping setting on driver

